

AN ORDINANCE AMENDING KING COUNTY ZONING RESOLUTION NO. 25789, AS AMENDED BY AMENDING THE ZONING MAP THEREOF RECLASSIFYING CERTAIN PROPERTY THEREON.

WHEREAS J. W. MORRISON, INC. has petitioned King County, requesting reclassification of property described in said petition and all legal requirements have been performed; and

WHEREAS, the Department of Planning has transmitted to the King County Council, King County, Washington, a copy of the Department's findings and action recommending that the Zoning Map be amended and for the reasons stated therein; and

NOW THEREFORE BE IT ORDAINED that the King County Council does hereby adopt the findings and recommendations of the Department of Planning as its own and does hereby reclassify certain property to RM 2400 as shown hereon and legally described herein which lies within the part(s) of the Zoning Map described as Area Map(s) E 16-26-4

RS-7,200

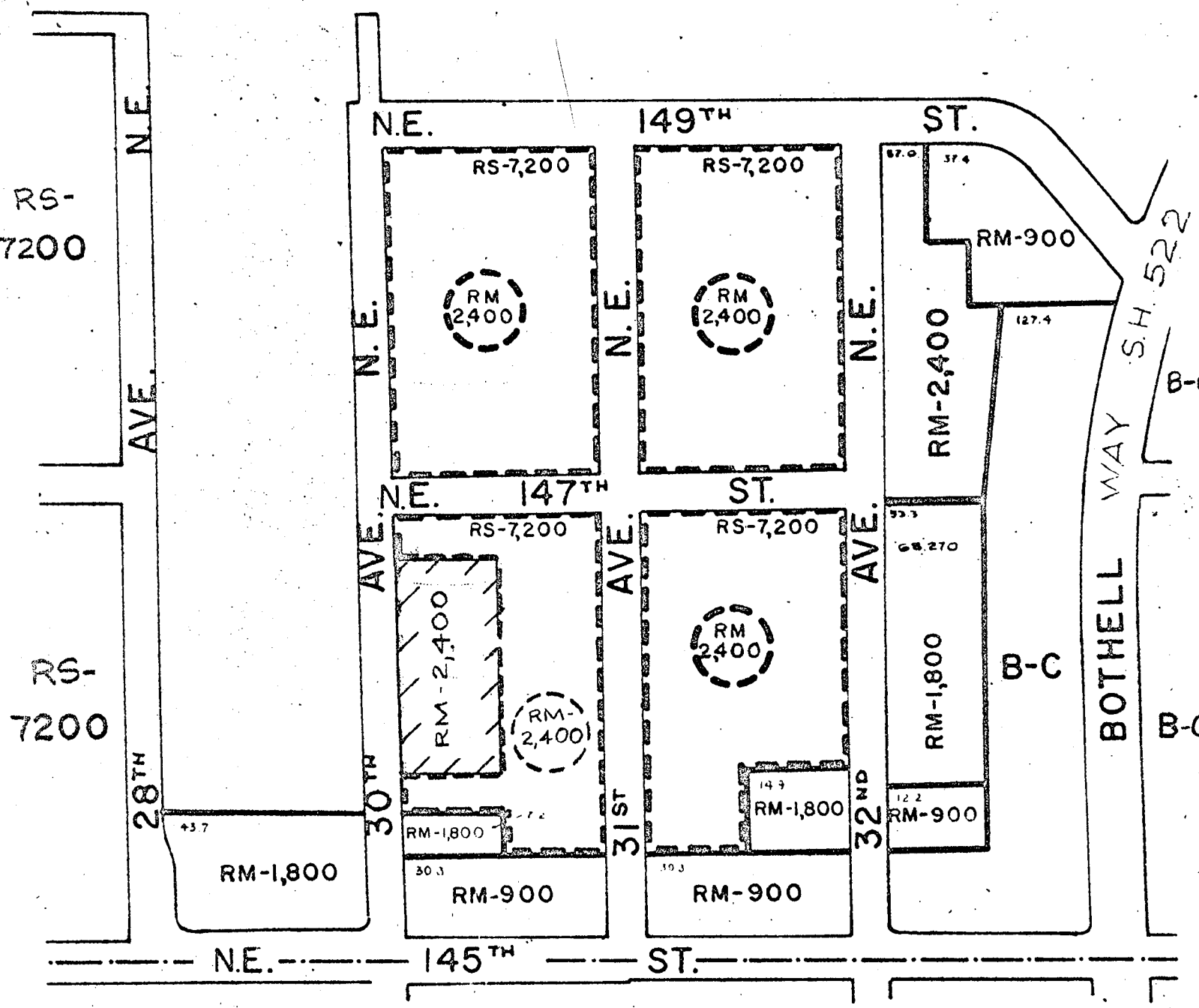

SEATTLE CITY LIMIT

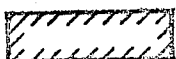

AREA RECLASSIFIED BY THIS RESOLUTION

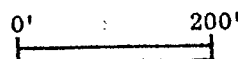

ST